

Unit 9a Eden Square Urmston



Unit 9a Eden Square Shopping Centre
Urmston M41 0NA

E Class Shop To Let

Contact:
Jonathan Thomas
01865 595143

jonathan@jrftcommercialproperty.co.uk

Location

Urmston is an affluent Manchester suburb that lies to the South West of Manchester City Centre and benefits from direct links to the M60 and national motorway network. Eden Square is anchored by a 52,000sq ft Sainsbury's and Argos with other national retailers including:

Aldi, Boots, Iceland, Greggs, Costa Coffee Card Factory, William Hill, Loungers and Anytime Fitness.

The centre has a 486 space car park with free parking for 3 hours, plus a 22,000 sq ft library and 76 fully occupied apartments.

Description

The shopping centre unit comprises a ground floor shop with rear loading access

Rent

£29,500 per annum exclusive

01865 595143



Suite 281, 266 Banbury Road, Summertown,
Oxford, OX2 7DL

Info@jrftcommercialproperty.co.uk

Unit 9a Eden Square Urmston

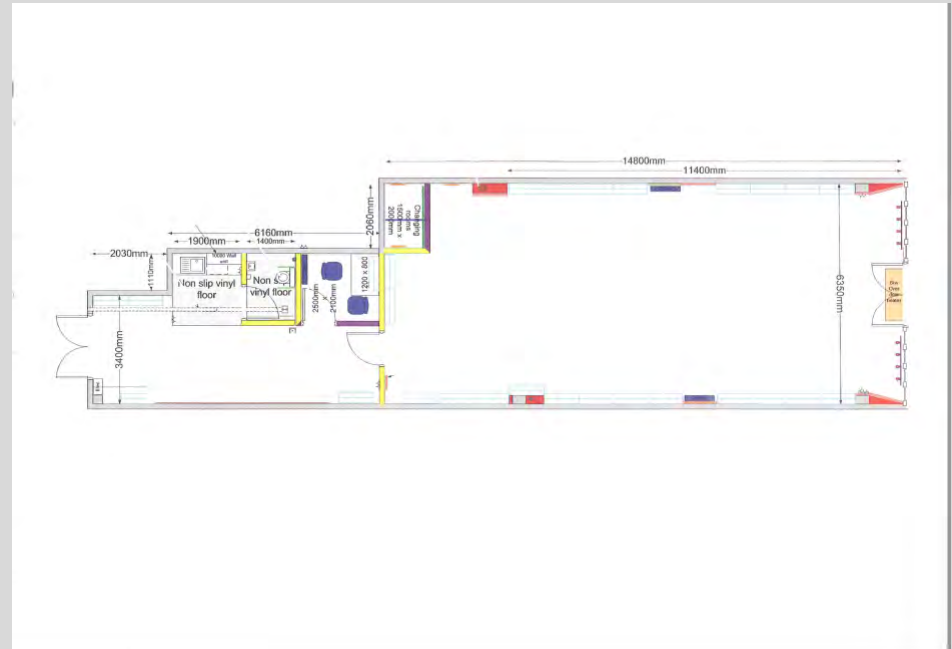
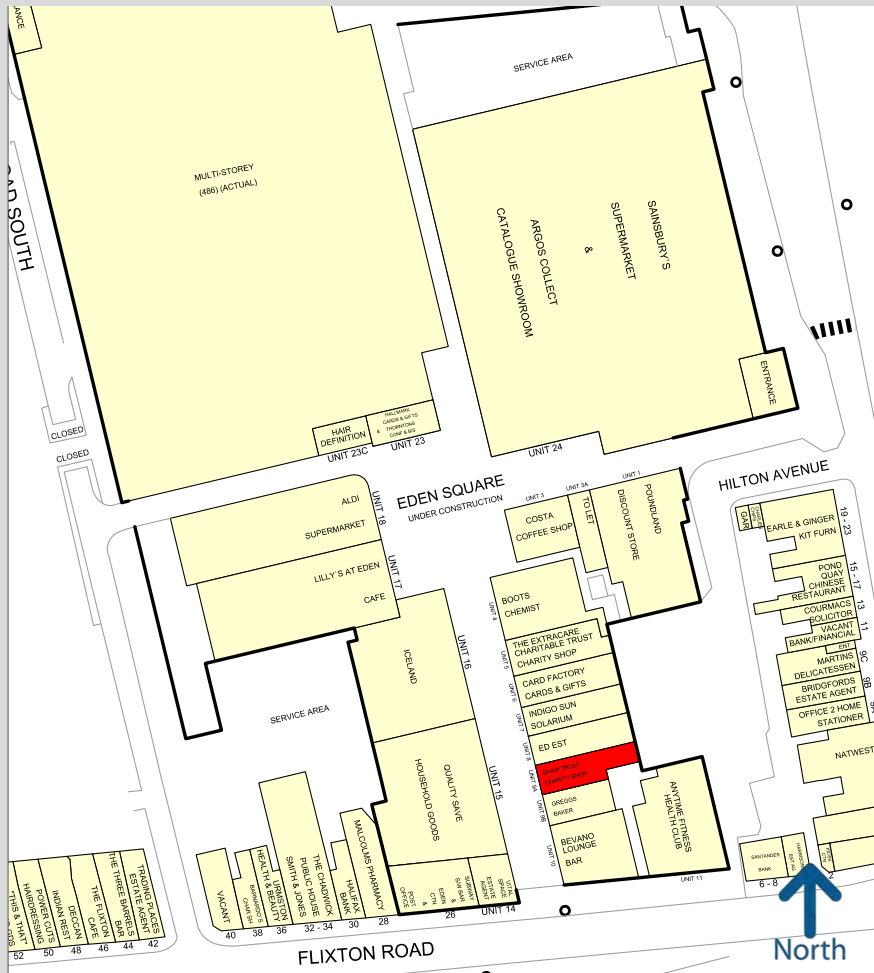

01865 595143



Suite 281, 266 Banbury Road, Summertown,
Oxford, OX2 7DL
Info@jrbtcommercialproperty.co.uk

Unit 9a Eden Square Urmston



Accommodation

The accommodation affords the following floor areas:

Ground: Sales 1,331 sq ft 123.65 sqm

Legal Costs

Each party will be responsible for their own legal costs incurred in this transaction.

Tenure

The premises are available by way of a new effectively full repairing and insuring lease on terms to be agreed.

Security of Tenure

The lease will be granted inside of the Landlord and Tenant Act 1954 (part 2).

Rating

Rateable Value:	£ tbc
UBR (2021/22)	0.499p
Notional Rates Payable	£ tbc

Interested parties should verify these figures with the Local Authority. Eligible businesses will get 100% rates relief until 30/6 followed by 66% relief to 31/3/22

Services

The property is connected to mains electricity, water and drainage, however, these have not been tested by the agents.

Service Charge

tbc

EPC

EPC Rating – B. Available on request.

VAT

All figures quoted are exclusive of VAT, where chargeable.

Viewing

Viewing is strictly by appointment via joint agents

JRBT Commercial Property Ltd
Jonathan Thomas - 01865 595143
jonathan@jrbtcommercialproperty.co.uk

Barker Proudlove
Jon Lovelady
07717 661389

SUBJECT TO CONTRACT

May 2021

JRBT Commercial Property Ltd (AND THEIR JOINT AGENTS WHERE APPLICABLE) FOR THEMSELVES AND FOR THE VENDORS OR LESSORS OF THIS PROPERTY FOR WHOM THEY ACT, GIVE NOTICE THAT: 1. These particulars are provided merely as a general guide to the property. They are not and shall not hereafter become part of any offer or contract; 2. JRBT cannot guarantee the accuracy of any description, dimensions, references to condition, necessary permissions for use and occupation and other details contained herein and prospective purchasers or tenants must not rely on them as statements of fact or representations and must satisfy themselves as to their accuracy; 3. No person in the employment of JRBT has any authority to make or give any representation or warranty whatever in relation to this property; 4. JRBT will not be liable in negligence or otherwise for any loss arising from the use of these particulars. 5. No liability is accepted for any travelling or other expenses incurred by applicants in viewing properties that may have been let, sold or withdrawn.

01865 595143



Suite 281, 266 Banbury Road, Summertown,
Oxford, OX2 7DL
Info@jrbtcommercialproperty.co.uk